

The range cooker that inspired Bob's hand-painted kitchen is easily visible as visitors ascend the stairs to the new room. The angled peninsula makes the most of the open space and doubles as a prep area

Beam me up



Bob Barton's topsy-turvy, rustic-style home provided his kitchen designer with a challenge



“My favourite design element is the arch-shaped peninsula. It creates a lovely little recess where I can prepare food and keeps the microwave out of sight”

Bob Barton

As people reach retirement age they usually decide to put their feet up and relax. Retired policeman, Bob Barton, however, chose to restore a couple of neglected local barns, which he'd recently bought. On completion, both properties proved too big for him, so he decided to downsize, converting a smaller barn into his now welcoming home.

Designed to make the most of the stunning views over the fields towards the Nottinghamshire villages, the property has an unusual, topsy-turvy layout. 'The striking vista is what makes this house special so it made sense to locate the living rooms and kitchen on the top floor, where I could enjoy the scenery, and position the bedrooms on the lower floor instead,' explains Bob.

When it came to planning the kitchen, Bob had seen a glossy blue range cooker from Britannia and knew instinctively that this statement-making appliance was what he needed at the centre of his design. 'Other than the range, I had no idea what I wanted,' he admits. 'I came across kitchen company Hill Farm Furniture by chance and when I met with designer Carolyn Ashwin the first thing I asked her was if she could plan me a kitchen around a dark blue range. I have to say she has risen to the challenge magnificently.'

Carolyn devised a simple, rustic design with beautiful hand-painted furniture, which sits easily with the sleek elegance of the range cooker, but also works with the building's period style. As the kitchen is the first area visible on mounting the stairs, Carolyn designed the space with cleverly proportioned, symmetrical cabinetry, which nestles under the roof's eaves, and a boomerang-shaped peninsula housing a preparation area. 'With limited space for wall units, the challenge was fitting in all the appliances and having room for storage without it looking cluttered,' explains Bob. 'Carolyn also managed to fit in a small, granite-topped dining table.'

'Initially, I did choose style over efficiency, but Carolyn was careful to make the design as practical as it is beautiful. Once people get over the fact that my house is upside down, the first thing they comment on is how smart my kitchen is,' smiles Bob. **BK**

TRADITIONAL



▲ Designed mainly as a place for Bob to sit at meal times, Carolyn has created a granite-topped breakfast bar similar in style to a traditional butcher's block. For similar wooden stools try John Lewis



◀ This newly converted, two-bedroom barn in Nottinghamshire is Bob Barton's new home. 'Having the kitchen at the top is a little strange, but it provides me with a perfect companion – the view,' he smiles

▶ Bob chose Halolite LED plinth lights from Screwfix to create discreet mood lighting. The richly coloured European oak flooring continues throughout the first floor to accentuate the open-plan feel. For similar try Kahrs



Pine furniture, painted in Palma Grey by Farrow & Ball, complements the blue range cooker; while the Marmorizado splashback tiles from I & S Ceramics provide a muted backdrop

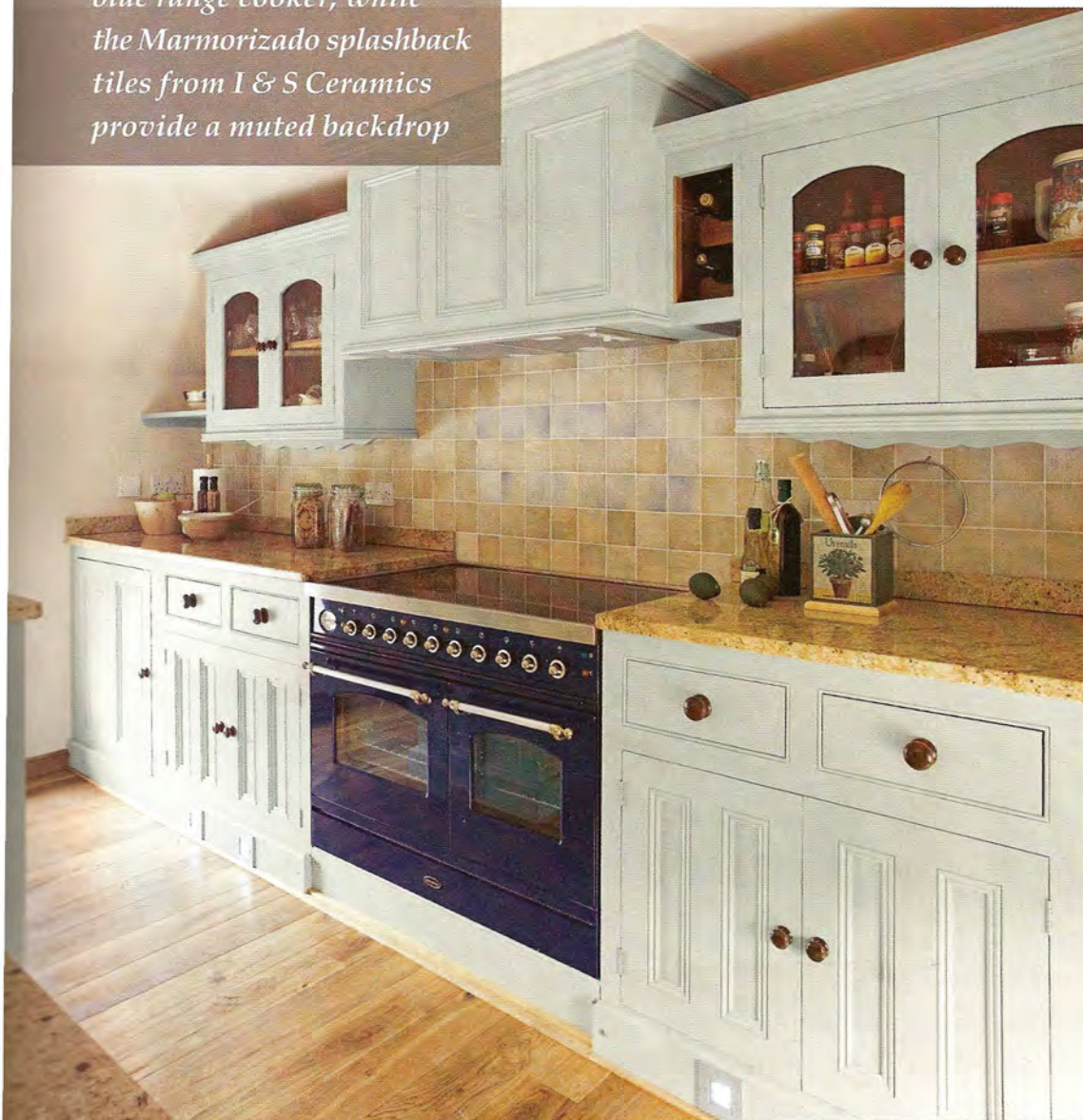

Where to buy Britannia 0800 073 1003 Farrow & Ball 01202 876141 Franke 0161 436 6280
I & S Ceramics 01909 486752 John Lewis 0845 604 9049 Kahrs 02392 453045 Neff 0870 513 3090
Perrin & Rowe 01708 526361 Screwfix 0500 414141 Stoneworld 01636 707640

THE KITCHEN FILE

DESIGN & CABINETRY

- Carolyn Ashwin at **Hill Farm Furniture**, Lodge Farm, Clensey Lane, Dry Doddington, Nr Newark, Notts NG23 5HT (01636 626063) www.hillfarmfurniture.co.uk
- Bespoke hand-painted Quebec yellow pine furniture with glass doors

WORKTOPS

- Madura Gold granite, Stoneworld. Price per linear m from **£300**

SINK & TAP

- VBK710 ceramic single-bowl sink, Franke **£254**
- 4751PF Provence two-hole mixer tap in pewter, Perrin & Rowe **£272**

APPLIANCES (shown)

- Classic 100 electric range cooker, Britannia **£2,800**
- D5855 canopy hood, Neff **£264**

APPLIANCES (not shown)

- Built-in microwave, Neff **£342**
- Fully integrated fridge, Neff **£290**
- Fully integrated freezer, Neff **£330**
- Fully integrated dishwasher, Neff **£450**

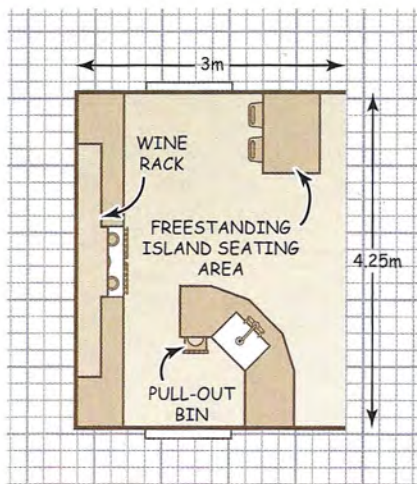

GUIDE PRICE

- Cabinetry only **£18,000**